

Title	Planning Applications		Page	4 of 7
Application number	15/0568		Scale @ A4	1:1,250
Address	FORMER CHESWYCKS SCHOOL, GUILDFORD ROAD, FRIMLEY GREEN, CAMBERLEY, GU16 6PB		Date	26-08-2015
Proposal	Outline application for the erection of a two storey building with accommodation in the roof to provide a 62 bedroom care home including car parking, landscaping, access and associated works. (Access, layout, appearance and scale to be determined). (
<p>© Crown Copyright. All rights reserved. Surrey Heath Borough Council 100018679 2015</p>				

SU/15/0568 – FORMER CHESWYCKS SCHOOL, GUILDFORD ROAD, FRIMLEY GREEN

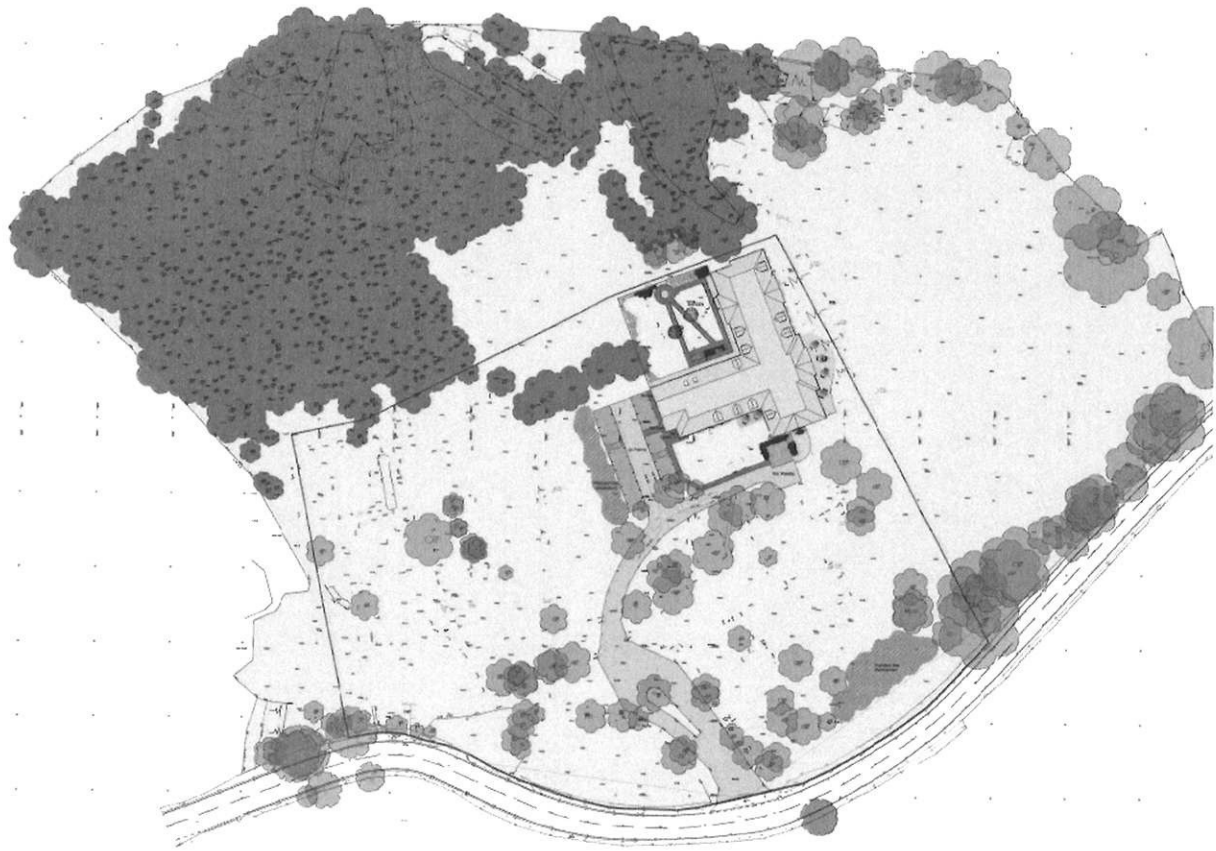

Elevation - North-East



Elevation - South-East



Elevation - North-West



Elevation - South-West

THIS DOCUMENT IS THE PROPERTY OF THE ARCHITECT AND IS NOT TO BE REPRODUCED OR TRANSMITTED IN ANY FORM OR BY ANY MEANS, ELECTRONIC OR MECHANICAL, INCLUDING PHOTOCOPYING, RECORDING, OR BY ANY INFORMATION STORAGE AND RETRIEVAL SYSTEM, WITHOUT THE WRITTEN PERMISSION OF THE ARCHITECT.

Rev.	Date	Description
1	10/2014	Issue for tender
2	03/2015	Revised drawings to reflect PCN & LPS
3	09/2014	Revised drawings

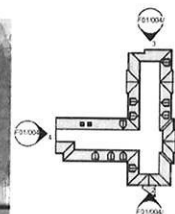

Elevation Key

GUILDFORD ROAD
FRIMLEY

SU/15/0568 – FORMER CHESWYCKS SCHOOL, GUILDFORD ROAD, FRIMLEY GREEN

